

# KABLO MERDİVENLERİ VE İÇ REDİKSİYON

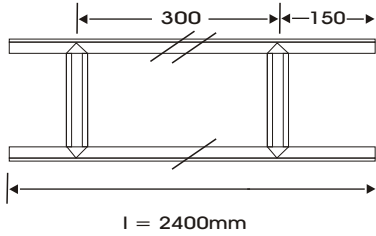

Sipariş Kod No ... B*H	W (mm)	e (mm)	Ağırlık (Kg/m)
GM-200-100-20	200	2,00	5,30
GM-250-100-20	250	2,00	5,36
GM-300-100-20	300	2,00	5,42
GM-400-100-20	400	2,00	5,55
GM-500-100-20	500	2,00	5,67
GM-600-100-20	600	2,00	5,80

## KABLO MERDİVENİ İÇİN REDİKSİYON

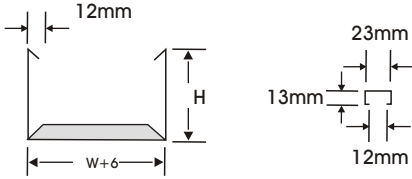
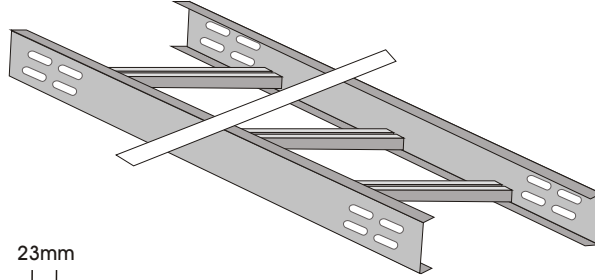
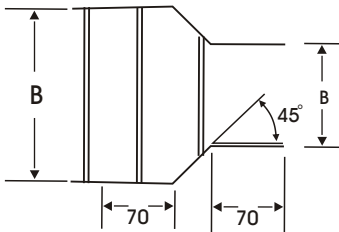
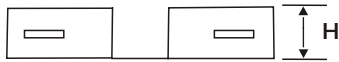
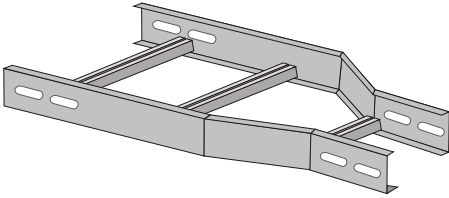

Sipariş Kod No ... B*H	W (mm)	e (mm)	Ağırlık (Kg/m)
GMR-200-40	200	1,50	1,02
GMR-250-40	250	1,50	1,10
GMR-300-40	300	1,50	1,40
GMR-400-40	400	1,50	1,52
GMR-500-40	500	1,50	1,64
GMR-600-40	600	1,50	1,71
GMR-200-60	200	1,50	1,32
GMR-250-60	250	1,50	1,38
GMR-300-60	300	1,50	1,82
GMR-400-60	400	1,50	1,96
GMR-500-60	500	1,50	2,08
GMR-600-60	600	1,50	2,23
GMR-200-100	200	2,00	2,40
GMR-250-100	250	2,00	2,50
GMR-300-100	300	2,00	2,60
GMR-400-100	400	2,00	2,72
GMR-500-100	500	2,00	2,91
GMR-600-100	600	2,00	3,20

e : Saç Kalınlığı (mm)

# KABLO MERDİVENİ YATAY DÖNÜŞLER

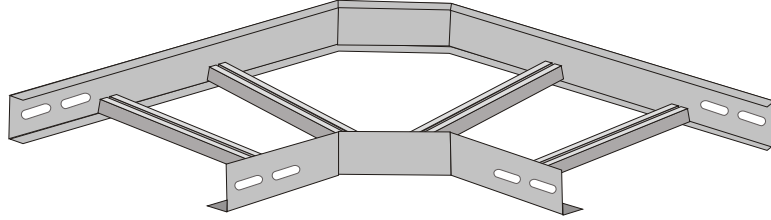

Sipariş Kod No ...w*H*e	W (mm)	e (mm)	Ağırlık (Kg/m)
GMY-100-40	100	1,50	1,52
GMY-150-40	150	1,50	1,72
GMY-200-40	200	1,50	1,92
GMY-250-40	250	1,50	2,14
GMY-300-40	300	1,50	2,34
GMY-400-40	400	1,50	2,90
GMY-500-40	500	1,50	3,22
GMY-600-40	600	1,50	3,75
GMY-100-60	100	1,50	1,72
GMY-150-60	150	1,50	1,98
GMY-200-60	200	1,50	2,12
GMY-250-60	250	1,50	2,38
GMY-300-60	300	1,50	2,52
GMY-400-60	400	1,50	3,10
GMY-500-60	500	1,50	3,45
GMY-600-60	600	1,50	3,95
GMY-200-60	200	2,00	4,28
GMY-250-60	250	2,00	4,80
GMY-300-60	300	2,00	5,12
GMY-400-60	400	2,00	5,90
GMY-500-60	500	2,00	6,70
GMY-600-60	600	2,00	7,40

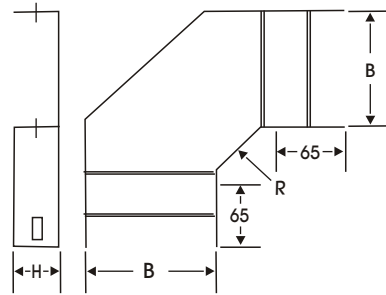

e= Saç Kalınlığı



## KABLO MERDİVENİ T GEÇİŞLERİ

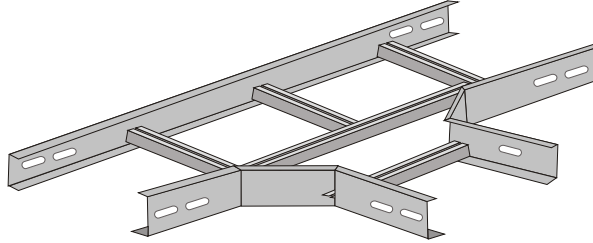

Sipariş Kod No  
...w\*H\*e

W  
(mm)

e  
(mm)

Ağırlık  
(Kg/m)

GMT-100-40	100	1,50	2,32
GMT-150-40	150	1,50	2,57
GMT-200-40	200	1,50	2,72
GMT-250-40	250	1,50	3,07
GMT-300-40	300	1,50	3,20
GMT-400-40	400	1,50	3,72
GMT-500-40	500	1,50	4,16
GMT-600-40	600	1,50	4,85
GMT-100-60	100	1,50	2,50
GMT-150-60	150	1,50	2,75
GMT-200-60	200	1,50	2,94
GMT-250-60	250	1,50	3,28
GMT-300-60	300	1,50	3,40
GMT-400-60	400	1,50	3,90
GMT-500-60	500	1,50	4,36
GMT-600-60	600	1,50	5,05
GMT-200-60	200	2,00	6,08
GMT-250-60	250	2,00	6,59
GMT-300-60	300	2,00	6,92
GMT-400-60	400	2,00	7,68
GMT-500-60	500	2,00	8,50
GMT-600-60	600	2,00	9,28

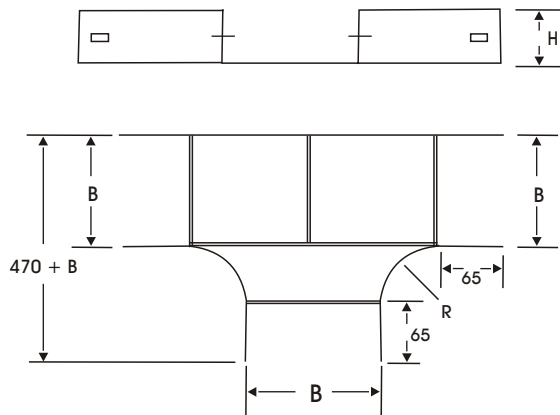

e= Saç Kalınlığı

# KABLO MERDİVENİ DÖRTLÜ GEÇİŞLER

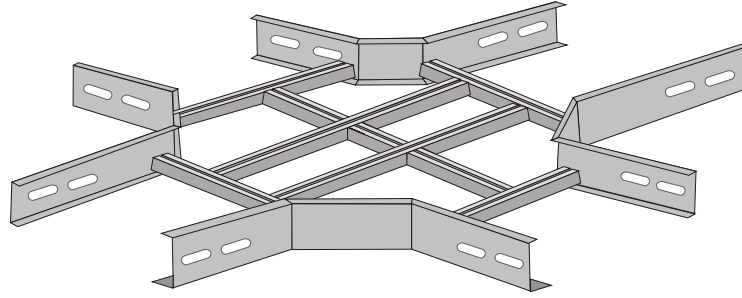

Sipariş Kod No ...B*H*e	B (mm)	e (mm)	Ağırlık (Kg/m)
GMX-100-40	100	1,50	2,87
GMX-150-40	150	1,50	3,15
GMX-200-40	200	1,50	3,34
GMX-250-40	250	1,50	3,67
GMX-300-40	300	1,50	3,85
GMX-400-40	400	1,50	4,15
GMX-500-40	500	1,50	4,60
GMX-600-40	600	1,50	5,10

GMX-100-60	100	1,50	3,03
GMX-150-60	150	1,50	3,36
GMX-200-60	200	1,50	3,54
GMX-250-60	250	1,50	3,88
GMX-300-60	300	1,50	4,05
GMX-400-60	400	1,50	4,36
GMX-500-60	500	1,50	4,80
GMX-600-60	600	1,50	5,30

GMX-200-60	200	2,00	4,78
GMX-250-60	250	2,00	4,92
GMX-300-60	300	2,00	5,08
GMX-400-60	400	2,00	5,32
GMX-500-60	500	2,00	5,60
GMX-600-60	600	2,00	5,86

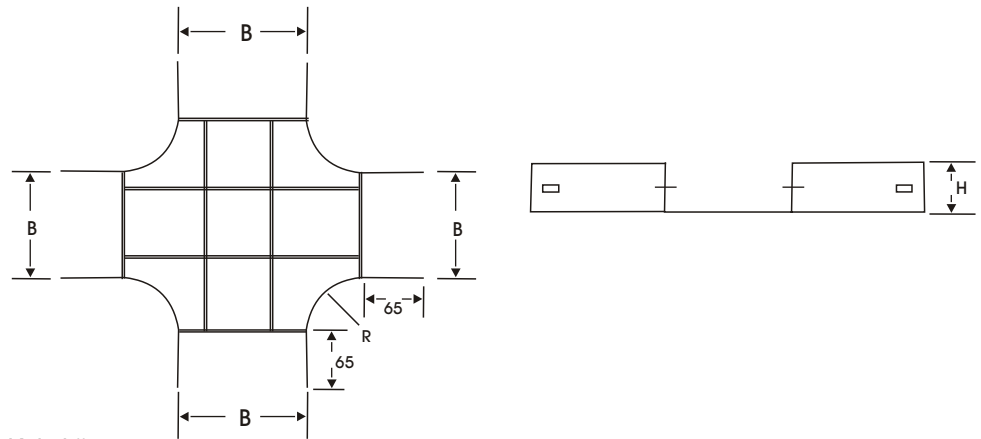

e= Saç Kalınlığı



## KABLO MERDİVENİ İÇ / DIŞ FLEKSİBİL DÖNÜŞLER

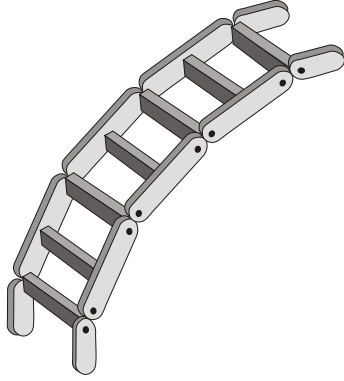

Sipariş Kod No ...w*H*e	W (mm)	e (mm)	Ağırlık (Kg/m)
GMF-100-40	100	1,50	2,10
GMF-150-40	150	1,50	2,20
GMF-200-40	200	1,50	2,30
GMF-250-40	250	1,50	2,38
GMF-300-40	300	1,50	2,50
GMF-400-40	400	1,50	2,70
GMF-500-40	500	1,50	2,96
GMF-600-40	600	1,50	3,20

GMF-100-60	100	1,50	2,30
GMF-150-60	150	1,50	2,40
GMF-200-60	200	1,50	2,50
GMF-250-60	250	1,50	2,60
GMF-300-60	300	1,50	2,70
GMF-400-60	400	1,50	2,80
GMF-500-60	500	1,50	3,10
GMF-600-60	600	1,50	3,20

GMF-200-60	200	2,00	4,79
GMF-250-60	250	2,00	4,90
GMF-300-60	300	2,00	5,10
GMF-400-60	400	2,00	5,30
GMF-500-60	500	2,00	5,60
GMF-600-60	600	2,00	5,90

